

# Piloting Mobile Supply Management Tools for Abortion Commodities

Innovation Grant

September 10, 2016



GENERAL MEMBERSHIP MEETING  
— of the —  
REPRODUCTIVE HEALTH  
SUPPLIES COALITION

10-14 OCTOBER 2016

#RHSUPPLIES2016



BILL & MELINDA  
GATES foundation

# Project Overview

- Adapt existing abortion commodity (MA & MVA) inventory control tools to use on a mobile phone or tablet
- Potential advantages of mobile tools:
  - May be easier to use, more accessible
  - Do not need the internet or a computer
  - Can use to email or text to share information / order immediately
- Pilot test the mobile tools with supply managers in the public sector and private sector supply chains to assess accuracy, feasibility and usability

## Participants and Training

- Recruited approximately 50 participants from 2 states in Nigeria (FCT and Ogun)
  - Mostly providers who manage their own supply
  - Predominantly from the private sector
- 1-day training in each state
  - Overview of project
  - Downloading the app
  - Practice scenarios to use app and apply to supply needs

# Data Collection & Field Support

- Baseline survey for all participants
- 3 months of data (usage log)
  - Participants will use the tool at least once per month, including entering data and texting/emailing the report
  - Goal is to have at least 3 reports per participant over 3 months
  - Participants will be supported by Ipas Nigeria staff
- Endline survey for all participants
- 5-10 users will participate in more in-depth interview at end of pilot study

# Ipas Manual Vacuum Aspirator Mobile Supply Calculator

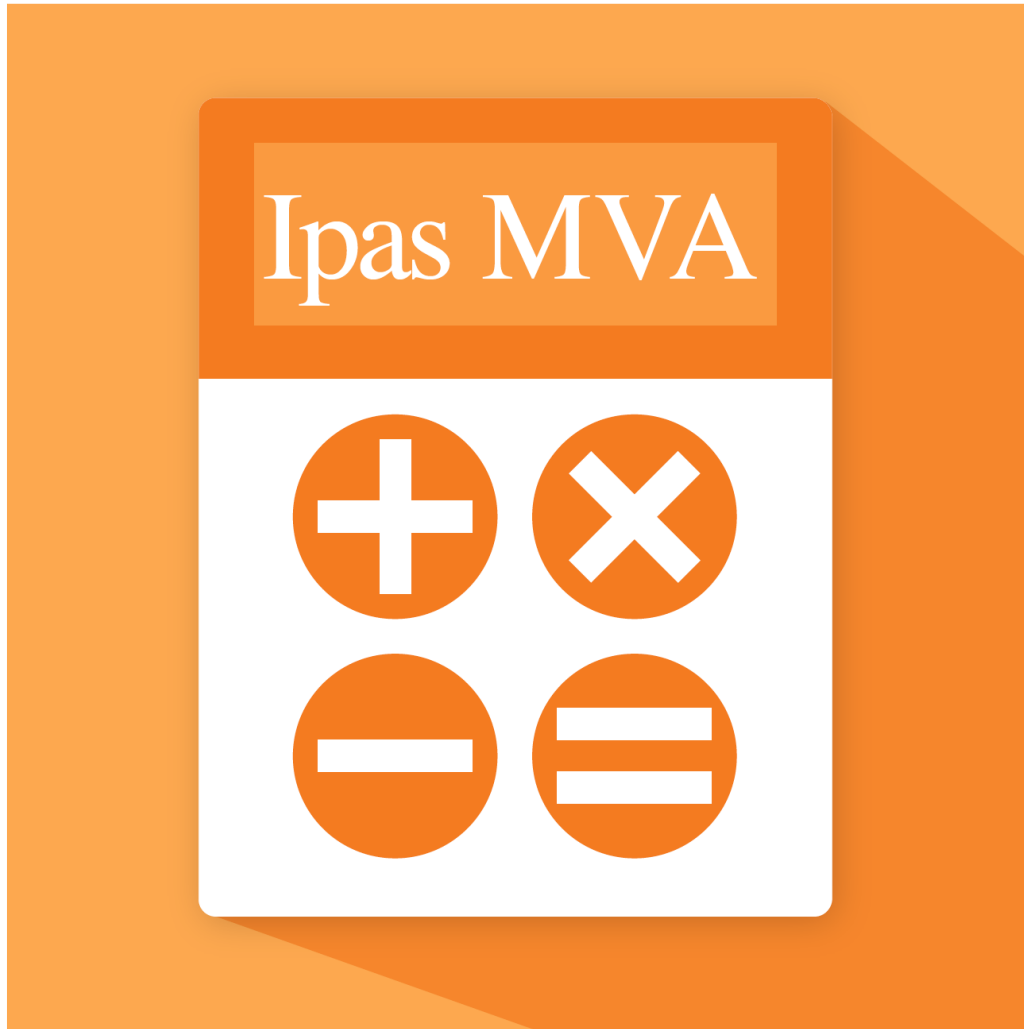

# Overview

- The MVA calculator is for health facility supply managers and distributors who calculate the number of manual vacuum aspirators (MVA) to keep in stock in health facilities.
- Using facility data, the Ipas MVA calculator will estimate appropriate quantities of Ipas MVA Plus® and Single-Valve aspirators to meet expected caseload.
- It uses a statistically based forecasting methodology developed by John Snow, Inc., based on average daily caseload and reuse factor for Ipas MVA instruments of 25.

# What does it do?

- The MVA calculator will help you quantify your needs for:
  - **Active Stock:** Number of MVA aspirators needed in the procedure room in ready-to-use condition to provide MVA services to all women who present for care on 95% of days.
  - **Reserve Stock:** New devices, still in their packaging, that are kept in the facility stockroom. They are used to replace active devices that are rendered unusable.
  - **Estimated needs for the year:** Total number of instruments a facility will need for a year based on its average daily case load, taking into account the number of days the facility is open.

# Ipas Medical Abortion Mobile Supply Calculator





# Overview

- The Ipas MA Supply Guidance Tool is a simple supply management tool that can be successfully used in service delivery settings that use misoprostol for postabortion care (PAC) as well as in settings where both misoprostol for PAC and induced abortion are available.
- This tool will enable you to quickly and easily calculate your facility's average monthly consumption of misoprostol and mifepristone, if used, and recommended minimum and maximum inventory levels.
- Includes an average of WHO recommended dosing for supply purposes

- Final project report due end of February (6 month total)
- Mobile apps will then be available free to the public through the Ipas website

# How to Access the Apps: Android



1. Open Chrome browser
2. Visit <http://www.ipas.org/Supply-Calculators/MVA> or <http://www.ipas.org/Supply-Calculators/MA>
3. Open the menu by tapping the  icon

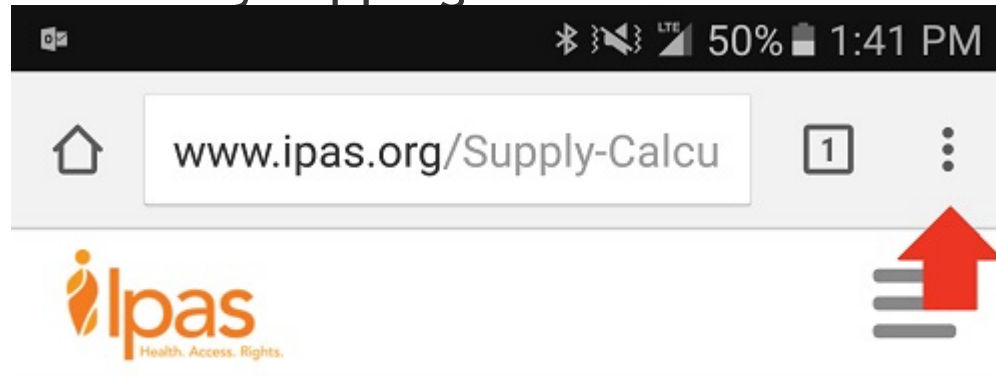

Medical Abortion (MA)

# How to Access the Apps: Android

## 4. Select 'Add to Home Screen'

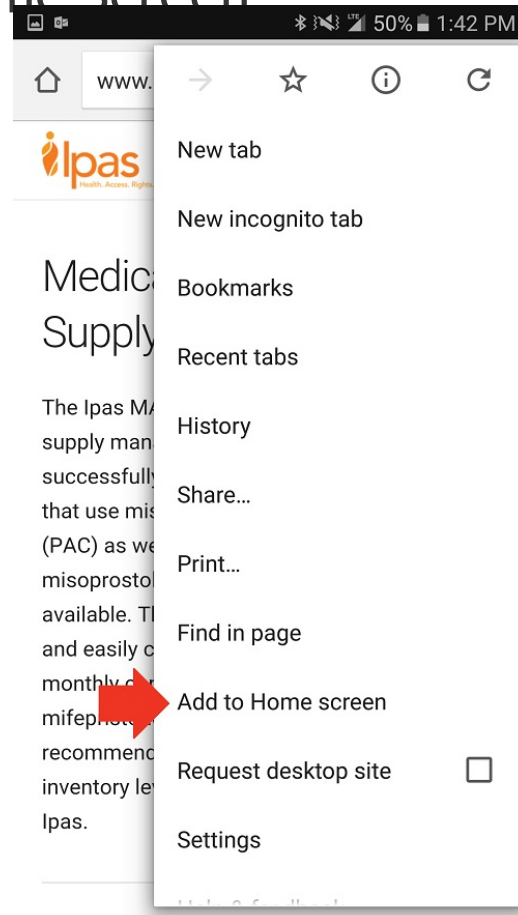

# How to Access the Apps: iOS

1. Open Safari browser



2. Visit <http://www.ipas.org/Supply-Calculators/MVA> or <http://www.ipas.org/Supply-Calculators/MA>

3. Tap the share icon

be successfully used in service delivery settings that use misoprostol for postabortion care (PAC) as well as in settings where both misoprostol for PAC and induced abortion are available. This tool will enable you to quickly and easily calculate your facility's average monthly consumption of misoprostol (and mifepristone, depending on your setting)



# How to Access the Apps: iOS

## 4. Tap 'Add to Homescreen'

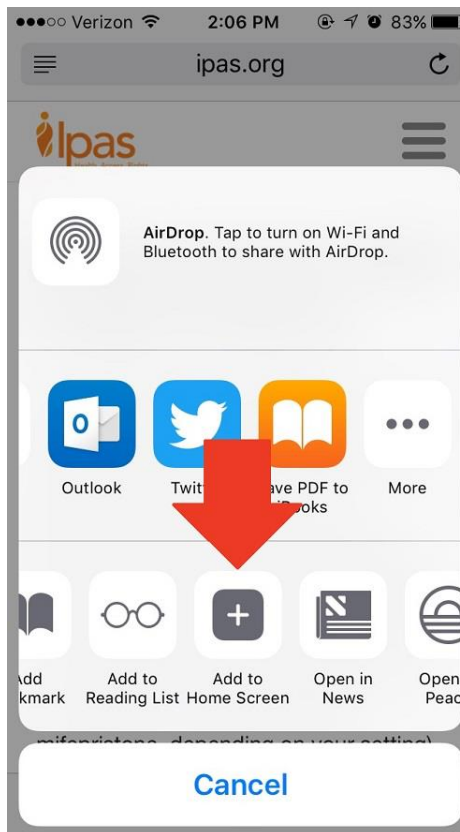

# How to Access the Apps: iOS

## 5. Tap 'Add'

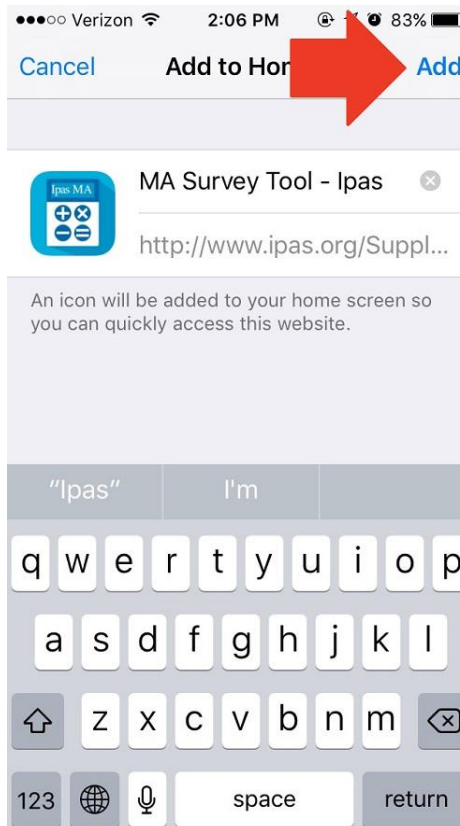

# Thank You!

#RHSUPPLIES2016